

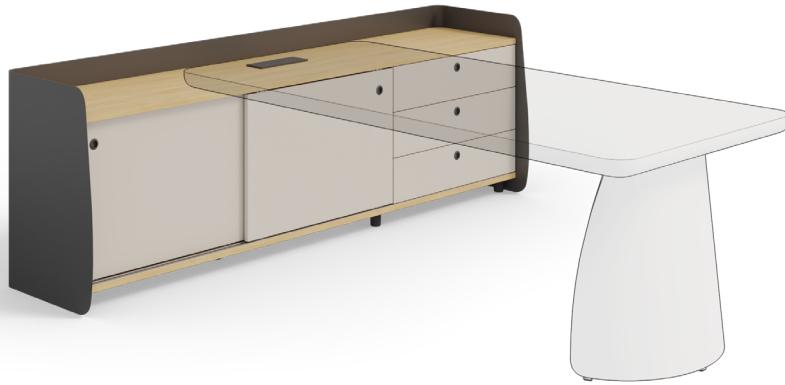

DOLMEN EXECUTIVE DESK SUPPORT CABINET

This support cabinet for executive desks offers high storage capacity with a design featuring rounded sides and friendly shapes, consistent with the rest of the Dolmen program. Its structure integrates fluidly under the desk, combining doors and drawers in a sophisticated aesthetic that maintains the visual coherence of the entire executive set.



STANDARD FEATURES

SOCKET BOX

- Centered socket box in the cabinet with a lid.
Color: Black (NE).
- 2 power outlets + USB A + USB C (Europe, France, UK, USA).

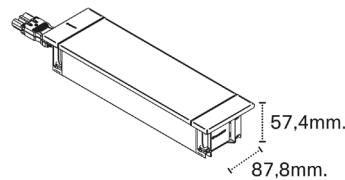

FALSE BACK

- False back inside the sliding door cabinet for cable routing.

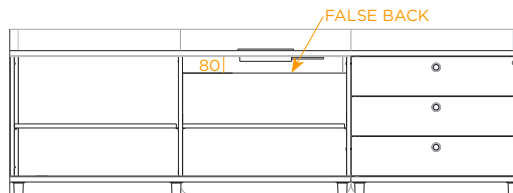

TECHNICAL SHEET



OPTIONAL FEATURES

CABLE GLAND

- Colour BA if top is BA.
Colour NE for other tops.

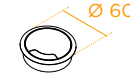

LOCK

- Master lock.



DESCRIPTION

ENCLOSURE

2 mm thick DC01 UNE-EN 10130 sheet metal shaped with a 40 mm radius on the rear corners.

These enclosures have welded metal inserts with M6 threads used to secure the enclosure to the furniture structure.

The entire set is painted with 60/80 micron epoxy powder paint, complying with current fire reaction regulations UNE 23827-90.

STRUCTURE

The cabinet interior, back, sides, and dividers are constructed in 19 mm thick wood particle board, glued with synthetic resins and specifically designed for applications requiring high resistance to bending, scratching, and staining, with an average density of 630 kg/m³ according to EN 14323. Bilaminated finish with 1 mm ABS edging according to UNE 56.843:01.

Fronts and doors have finish options in wood, HPL, LINOLEUM, and melamine in 20 mm thickness. The top is ≈26 mm thick in wood, HPL, LINOLEUM, and melamine finishes.

DOORS

Sliding doors on aluminum profiles recessed into the base and top of the cabinet, with a Soft braking system.

DRAWERS

Drawers with hidden ball-bearing sliding guides and metal sides. They feature full extension, a Soft-close system, and 3D front adjustment.

SHELVES

Constructed in 19 mm thick wood particle board, glued with synthetic resins and specifically designed for applications requiring high resistance to bending, scratching, and staining, with an average density of 630 kg/m³ according to EN 14323 standard. Bilaminated finish with 1 mm ABS edging according to UNE 56.843:01 standard.

Height-adjustable with a 28 mm pitch.

Shelf load resistance according to UNE EN 14073-3:05: 49 kg.



DOLMEN EXECUTIVE DESK SUPPORT CABINET

TECHNICAL SHEET



RECYCLABILITY RATE



RECYCLED MATERIAL



RECYCLABLE

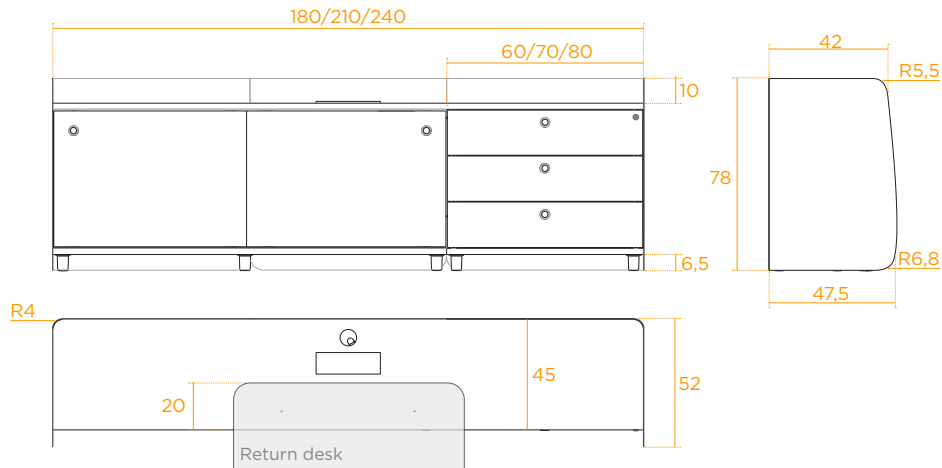

RANGE

► Right hand

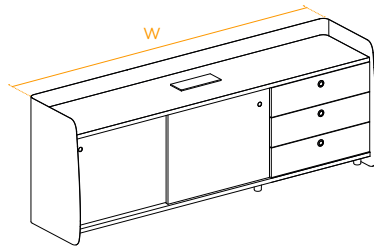

| | 180 | 210 | 240 |
|---|-----|-----|-----|
| W | ● | ● | ● |

► Left hand

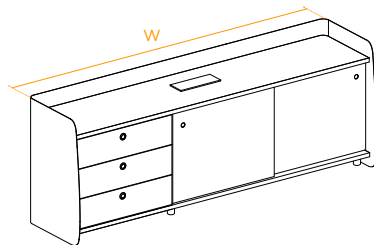

| | 180 | 210 | 240 |
|---|-----|-----|-----|
| W | ● | ● | ● |

KEY

PRICE TERMS

● GENERAL